

- 1 Zircaloy Bearing Pad
- 2 Zircaloy Fuel Cladding
- 3 Zircaloy End Support
- 4 Uranium Dioxide
- 5 Canlyb Graphite Interlayer
- 6 Interelement Spacer
- 7 Zircaloy End Cap

FUEL BUNDLE DIMENSIONS :-
OUTSIDE DIAMETER = 100mm
LENGTH = 495mm

FUEL BUNDLE WEIGHT = 24.57 Kg

Figure 1 – CANDU Fuel Bundle

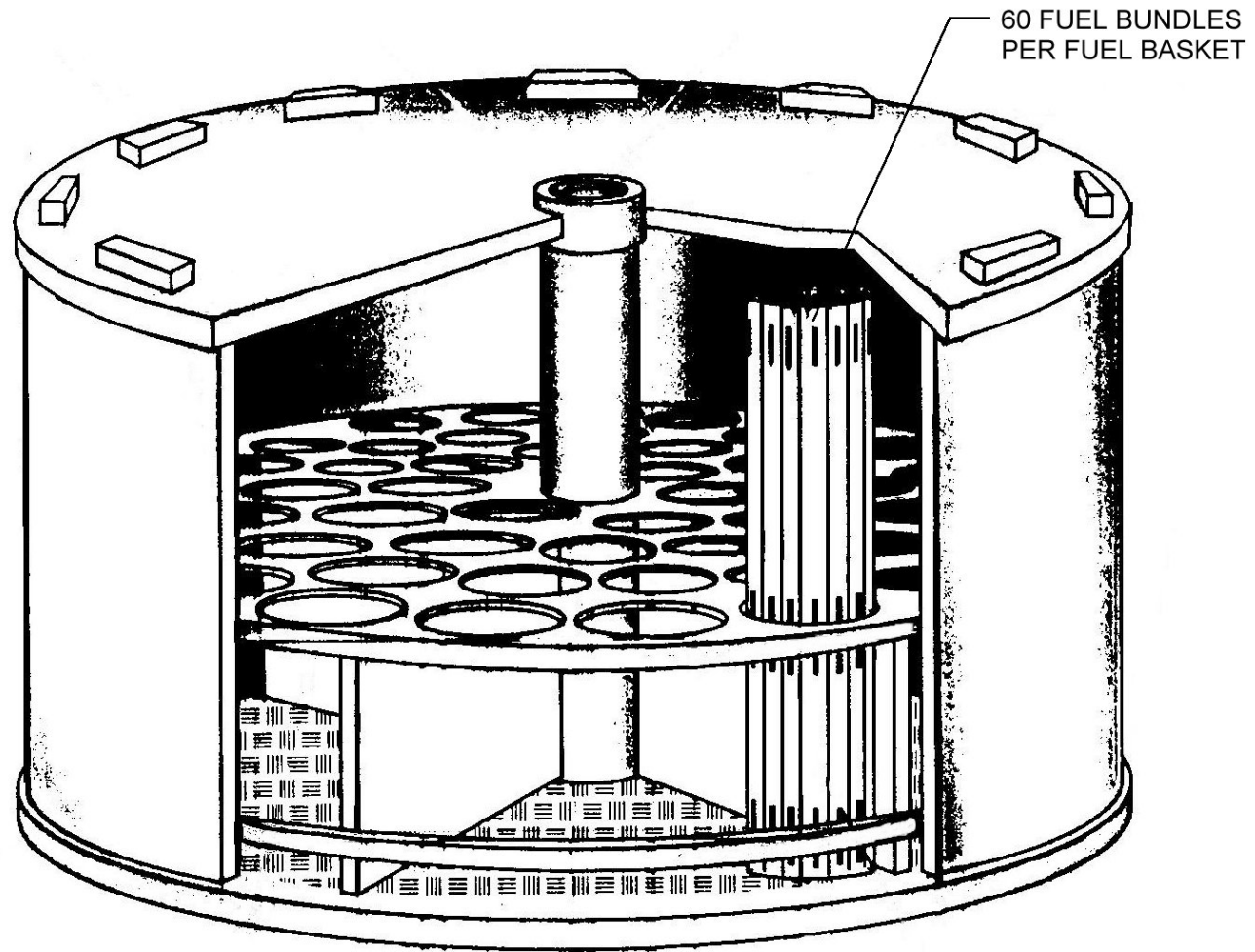

FUEL BASKET WEIGHTS:-
EMPTY = 450 Kg
FULLY LOADED = 1924 Kg
(60 FUEL BUNDLES)

Figure 2 – Fuel Basket

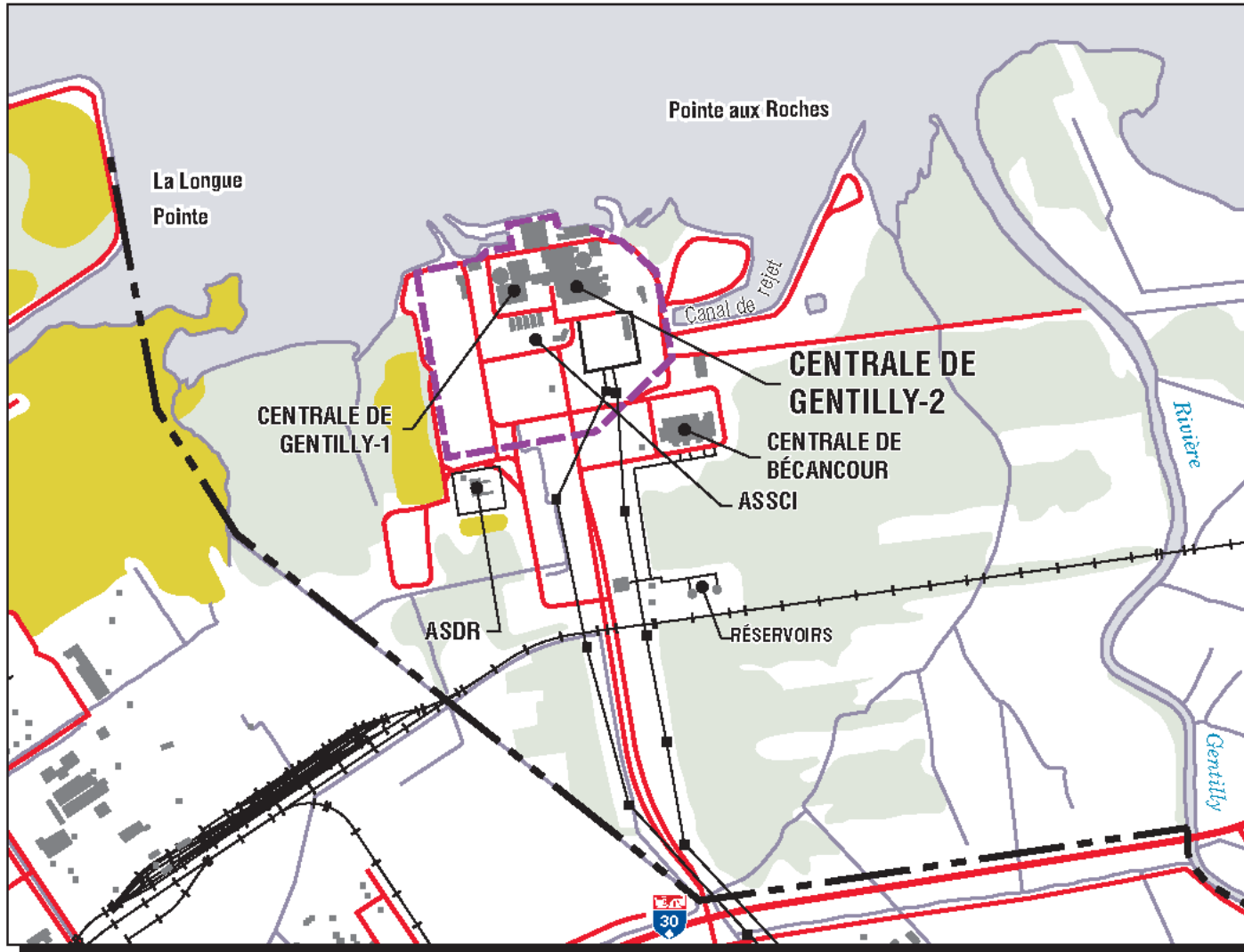

Figure 3
Hydro-Québec Site - Plan



Figure 4. Gentilly Site Looking North.



Figure 5. Gentilly Site Looking East.

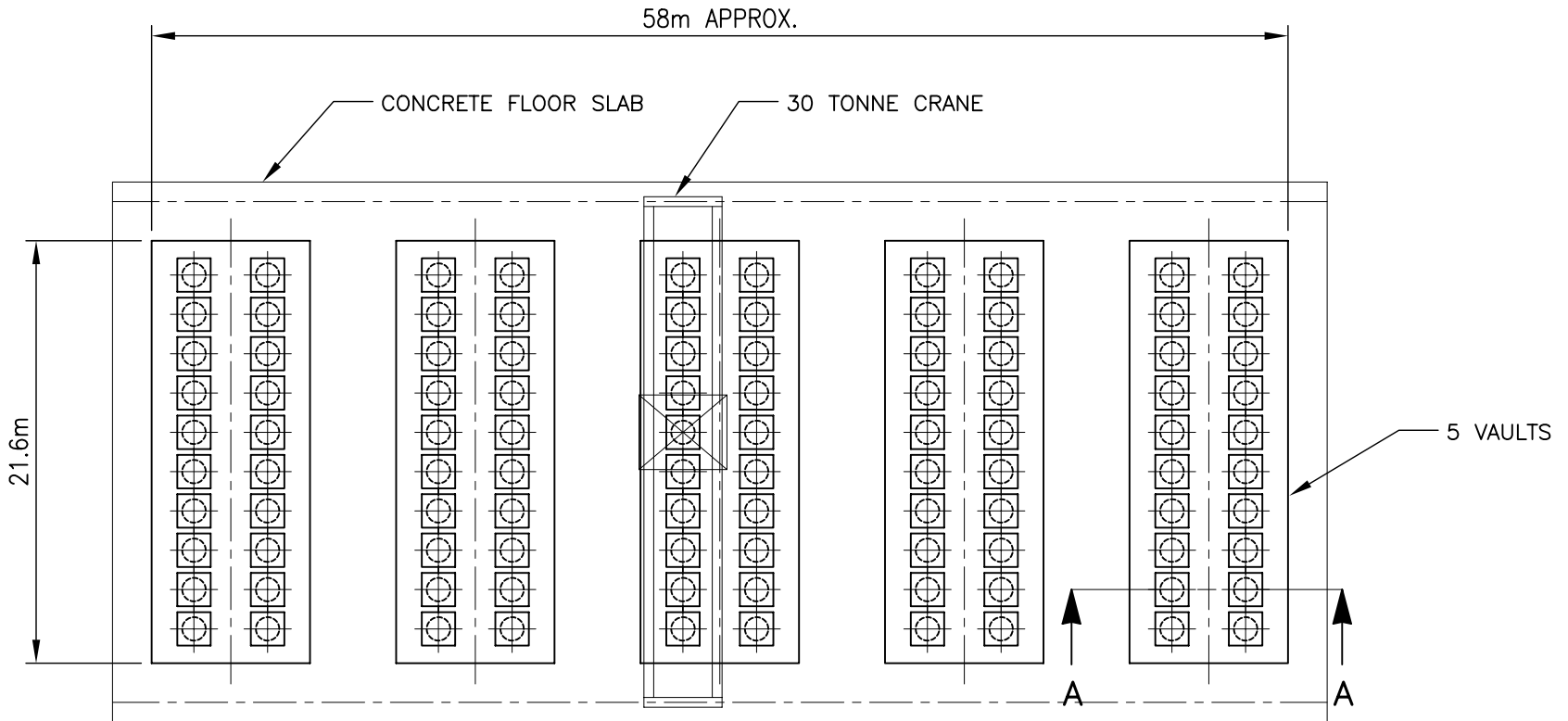

FOR SECTION SEE FIGURE 8



FIGURE 6
VAULTS
CURRENT STORAGE FACILITY – PLAN
HYDRO QUÉBEC – GENTILLY

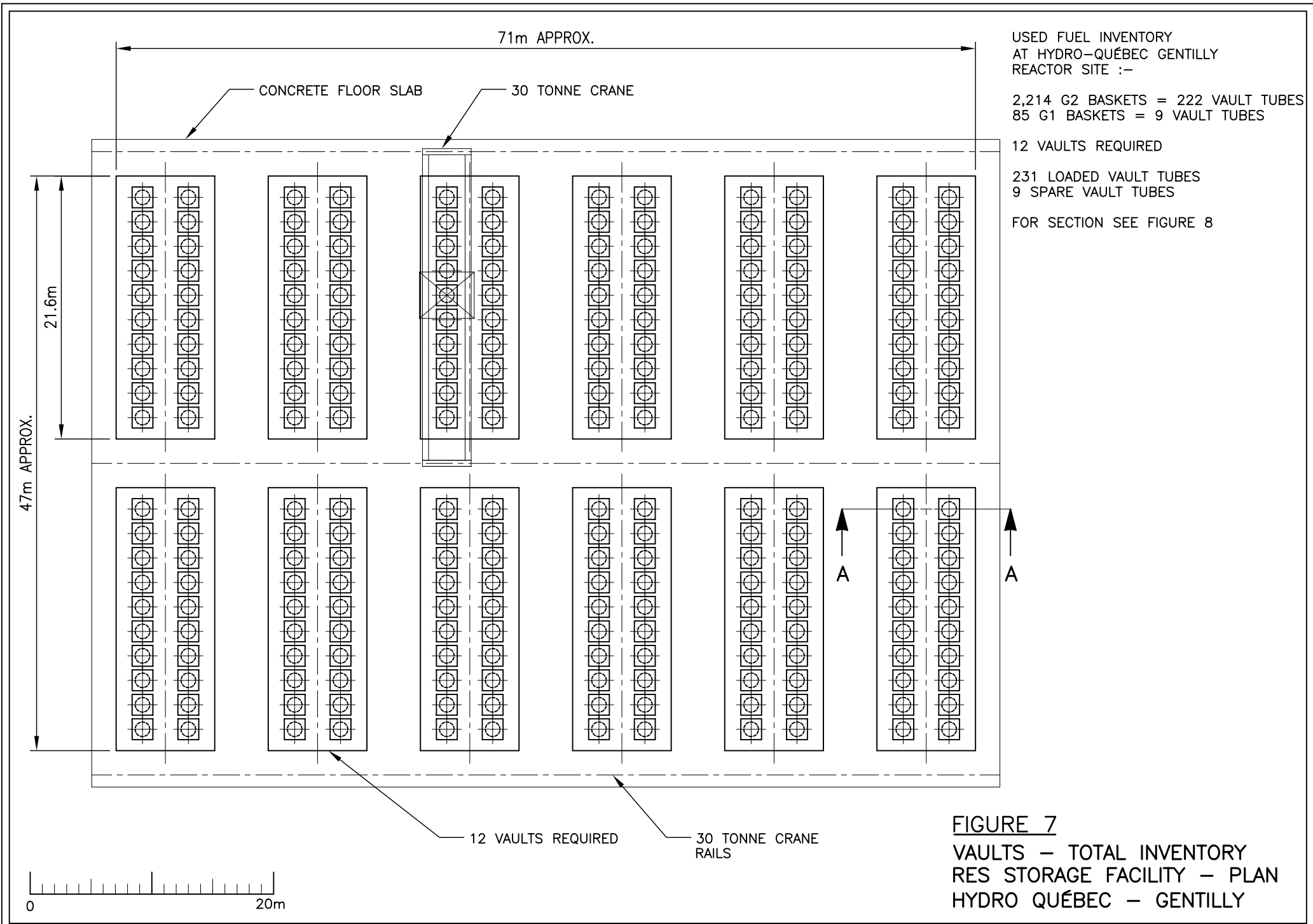

USED FUEL INVENTORY
AT HYDRO-QUÉBEC GENTILLY
REACTOR SITE :-

2,214 G2 BASKETS = 222 VAULT TUBES
85 G1 BASKETS = 9 VAULT TUBES

12 VAULTS REQUIRED

231 LOADED VAULT TUBES
9 SPARE VAULT TUBES

FOR SECTION SEE FIGURE 8

FIGURE 7
VAULTS - TOTAL INVENTORY
RES STORAGE FACILITY - PLAN
HYDRO QUÉBEC - GENTILLY

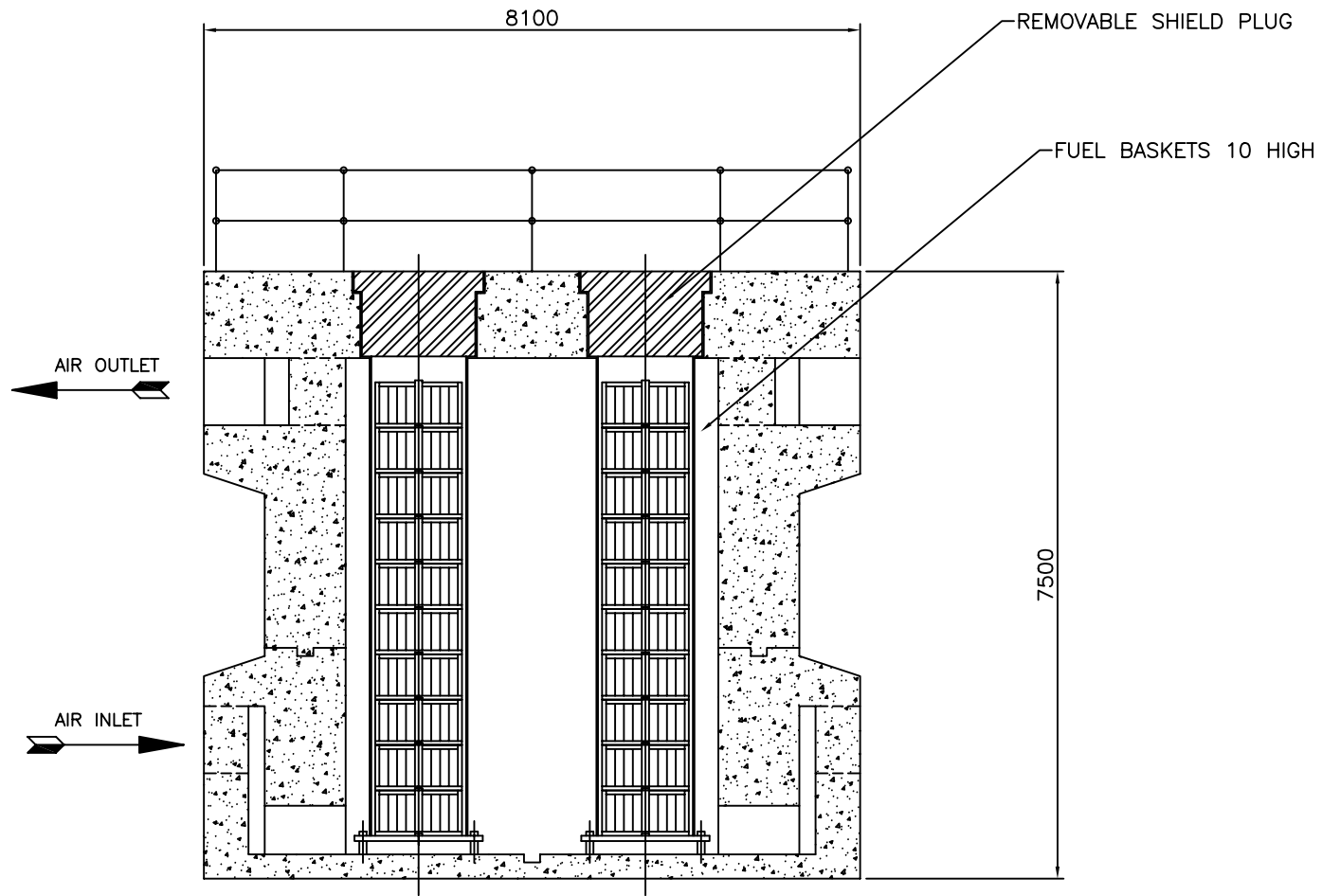

SECTION 'A'-'A'
FROM FIGURES 6 & 7

FIGURE 8
VAULT SECTION

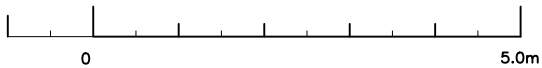

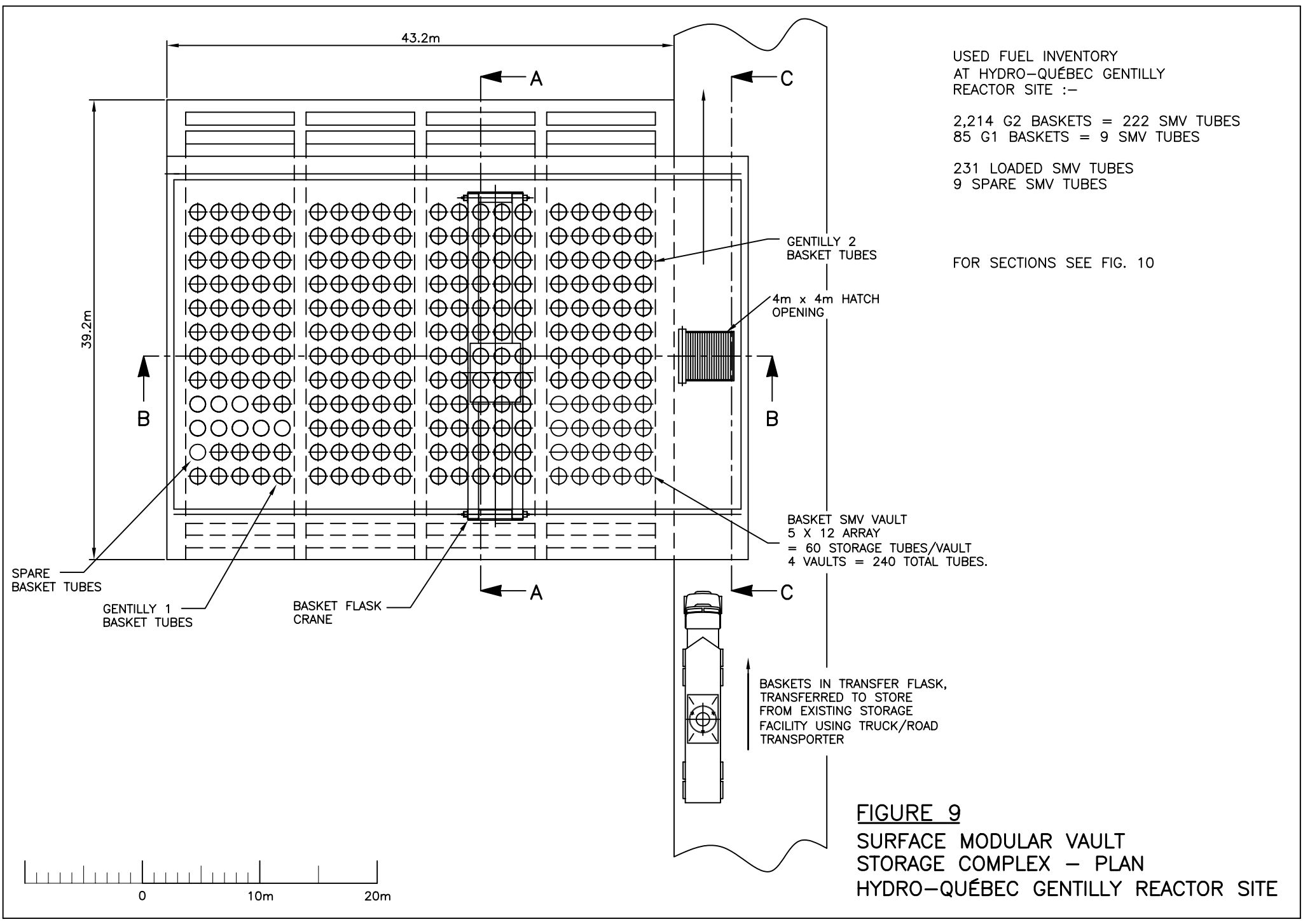

USED FUEL INVENTORY
AT HYDRO-QUÉBEC GENTILLY
REACTOR SITE :-

2,214 G2 BASKETS = 222 SMV TUBES
85 G1 BASKETS = 9 SMV TUBES

231 LOADED SMV TUBES
9 SPARE SMV TUBES

FOR SECTIONS SEE FIG. 10

GENTILLY 2
BASKET TUBES

4m x 4m HATCH
OPENING

BASKET SMV VAULT
5 X 12 ARRAY
= 60 STORAGE TUBES/VAULT
4 VAULTS = 240 TOTAL TUBES.

BASKETS IN TRANSFER FLASK,
TRANSFERRED TO STORE
FROM EXISTING STORAGE
FACILITY USING TRUCK/ROAD
TRANSPORTER

FIGURE 9
SURFACE MODULAR VAULT
STORAGE COMPLEX - PLAN
HYDRO-QUÉBEC GENTILLY REACTOR SITE

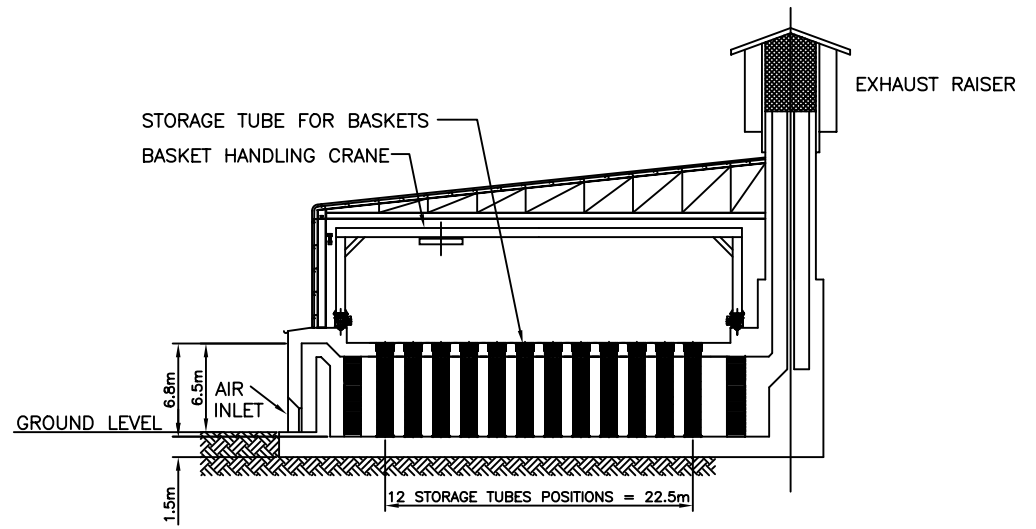

SECTION A-A
FROM FIGURE 9

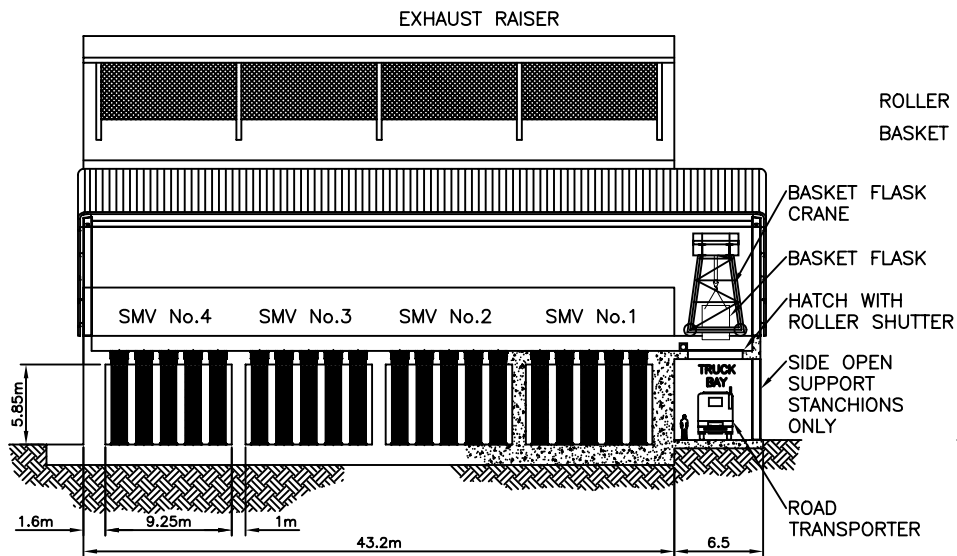

SECTION B-B
FROM FIGURE 9

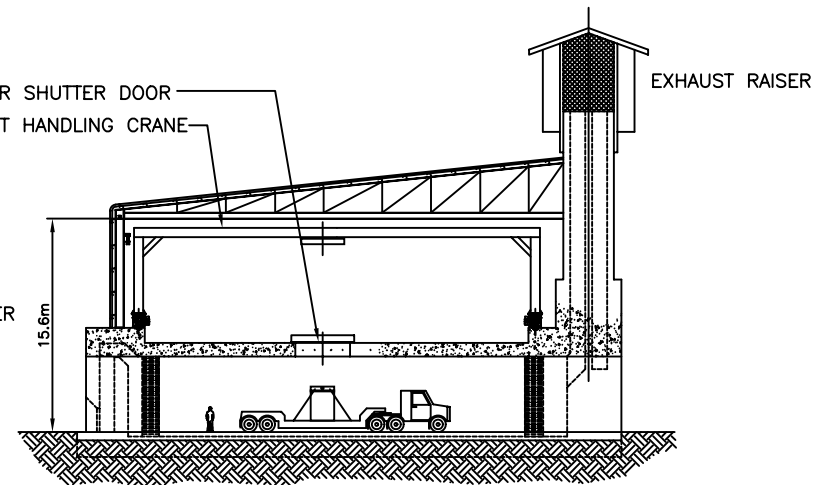

SECTION C-C
FROM FIGURE 9



FIGURE 10
SURFACE MODULAR VAULT
STORAGE COMPLEX – SECTIONS
HYDRO-QUÉBEC GENTILLY REACTOR SITE

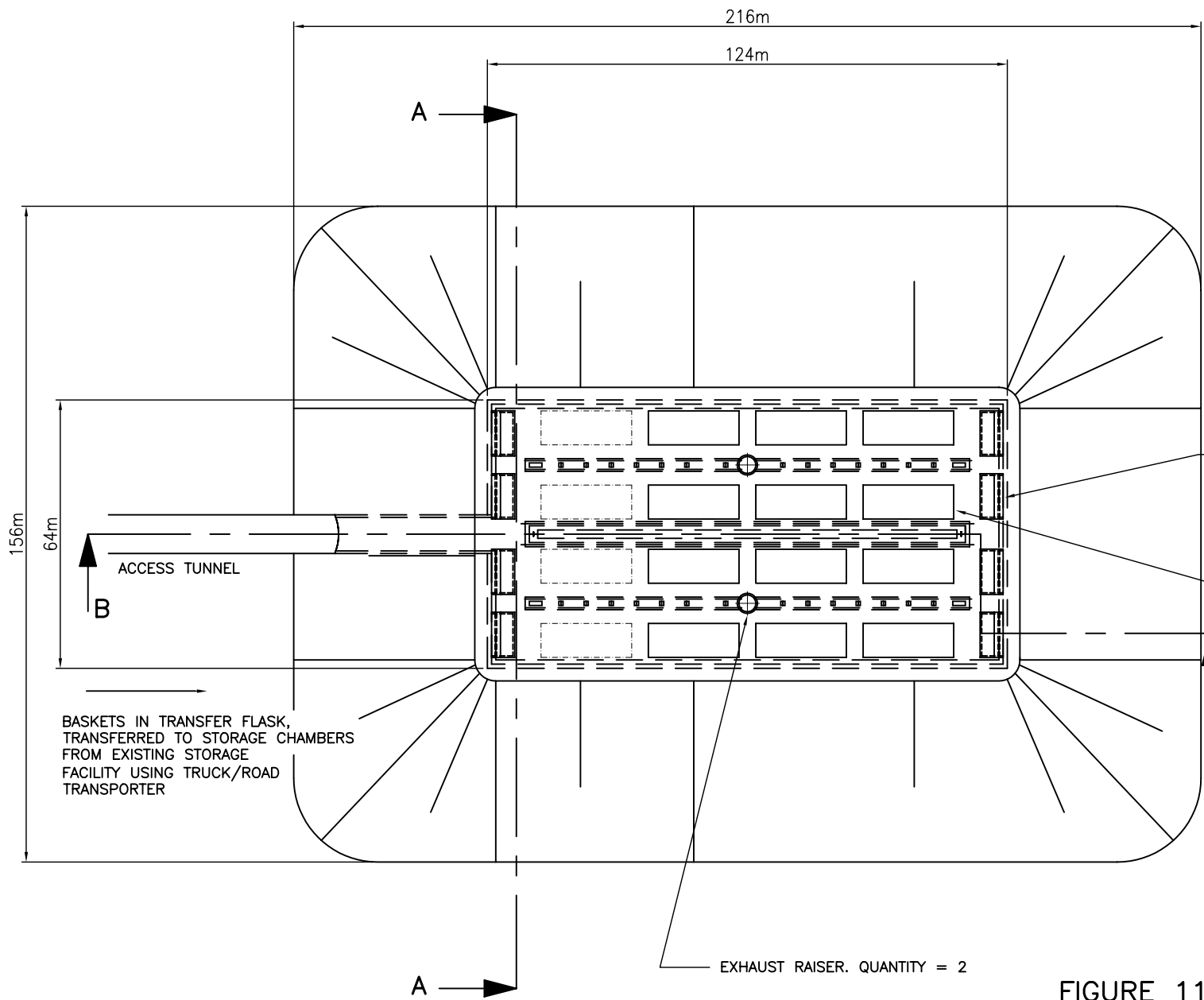

USED FUEL INVENTORY
AT HYDRO-QUÉBEC GENTILLY
REACTOR SITE :-

2,214 G2 BASKETS = 222 VAULT TUBES
85 G1 BASKETS = 9 VAULT TUBES

12 VAULTS REQUIRED

231 LOADED VAULT TUBES
9 SPARE VAULT TUBES

FOR SECTIONS SEE FIG. 12

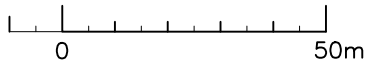
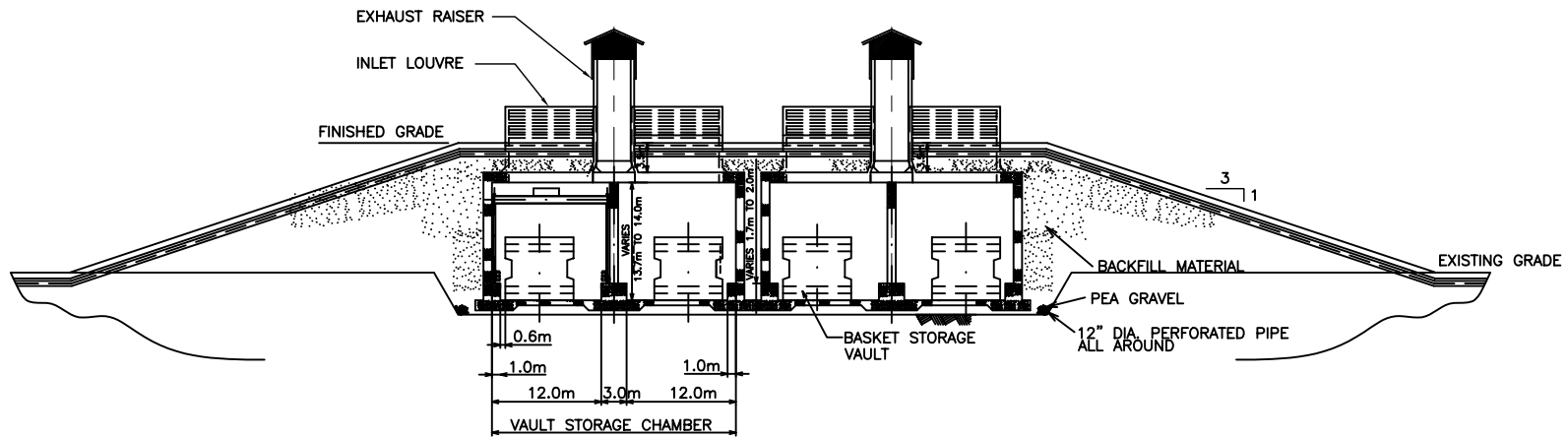
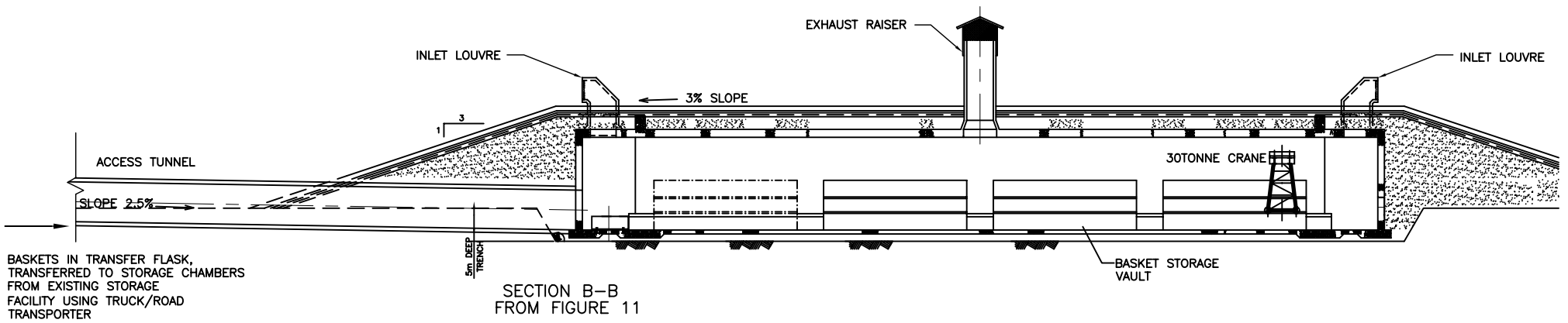

FIGURE 11
VAULTS IN A SHALLOW TRENCH
STORAGE CHAMBERS – PLAN
HYDRO-QUÉBEC GENTILLY REACTOR SITE



SECTION A-A
FROM FIGURE 11



SECTION B-B
FROM FIGURE 11

BASKETS IN TRANSFER FLASK,
TRANSFERRED TO STORAGE CHAMBERS
FROM EXISTING STORAGE
FACILITY USING TRUCK/ROAD
TRANSPORTER

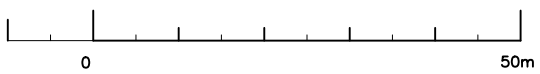

FIGURE 12
VAULTS IN A SHALLOW TRENCH
STORAGE CHAMBERS – SECTIONS
HYDRO-QUÉBEC GENTILLY REACTOR SITE